

ACCUline DCT-C

Customisable solid-core residual current transformer

from 36 to 630 A per phase – 3 mA to 30 A of fault current

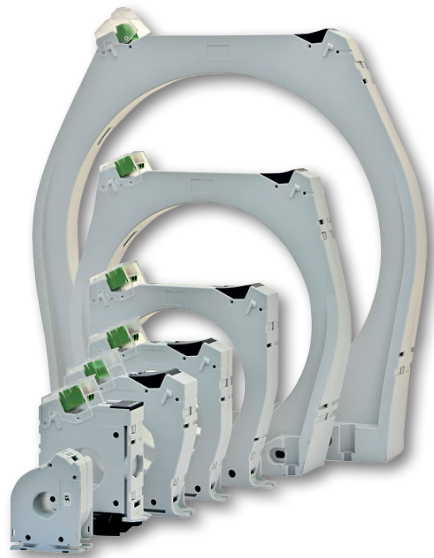

core_1127.psd

The solution for

- > Data centres
- > Energy
- > Infrastructure & Transport
- > Industry
- > Buildings

Strong points

- > Wide range of measurement
- > High immunity
- > Suitable for all cable diameters
- > Infinitely customisable
- > Universal

Conformity to standards

- > IEC 61869-1
- > IEC 60947-2 Annex M
- > IEC 62020
- > UL 508

Function

DCT-C solid-core residual current transformers are designed to measure type A residual current. If there are no faults, the vector sum of the currents is zero. DCT-C cores perform a vector sum of currents in the circuit to identify any anomalies. They are designed for residual current protection and monitoring.

Advantages

Wide range of measurement

The DCT-C range offers a wide current range, from 36 to 630 A per phase, in accordance with IEC 61869-1.

High immunity

The accuracy of the DCT-C range comes from the integral winding around the core. It thereby eliminates the measurement errors associated with the arrangement of the conductors.

Suitable for all cable diameters

The DCT-C ranges offers an unequalled variety of sizes, from 17 to 300 mm. This enables selection of the core most suitable for the application.

Infinitely customisable

From primary current to transformation ratio, the technical specifications are fully customisable.

Universal

The secondary output voltage adapts to any differential and protection relays.

ACCULine DCT-C

Customisable solid-core residual current transformer
from 36 to 630 A per phase – 3 mA to 30 A of fault current

Current transformers adaptable to all your requirements

Socomec's DCT-C range can meet all your requirements thanks to its high capacity for customisation. From primary current to transformation ratios, the technical specifications can be adjusted to perfectly align with the requirements of your installation.

List of customisable characteristics

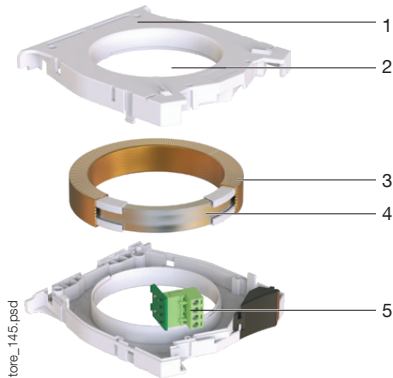

1. Product type:
 - Solid-core current transformer
2. Window size
 - 15...300 mm
3. Transformation ratio
 - 500...8000/1
4. Per-phase current:
 - 36...630 A
 - Fault current:
 - 3 mA ...30 A
5. Secondary signal:
 - 10...100 mV
 - Output type:
 - Terminal block
 - Pre-wired

Selection guide

Need to configure your current transformers? Use the table below to guide your selection. Start by selecting the dimensions of your frame. The technical specifications can be fully adapted. The rated operational current (A) represents the current flowing in a single phase, while the rated primary current (A) represents the residual current of the installation, also known as the fault current.

Parameters	DCT-C-17	DCT-C-30	DCT-C-50	DCT-C-80	DCT-C-120	DCT-C-200	DCT-C-300	without frame
Rated operational current (A)	36	65	85	160	250	400	630	Contact us
Primary rated current range (A)	0.003...30							
Window size (mm)	17	30	50	80	120	200	300	
Transformation ratio	500/1...8000/1							
Secondary signal	10...100 mV							
Frequency (Hz)	50...60							
Output type	Terminal block Pre-wired							
Phase-neutral voltage	300 V							
Measurement category	CAT III							
Rated withstand voltage	3 kV							
IP Rating	IP20 / IK 07							
Operating altitude	<2000							
Operating temperature	-10...+70 °C							
Storage temperature	-25...+85 °C							

References

The ACCULine range offers the ability to adjust all parameters to create the perfect current transformer for your requirements. Do not hesitate to ask for advice or to obtain a quote by contacting your local Socomec dealer.

ACCULine DCT-C

Customisable solid-core residual current transformer

from 36 to 630 A per phase – 3 mA to 30 A of fault current

Dimensions (mm)

DCT-C-17

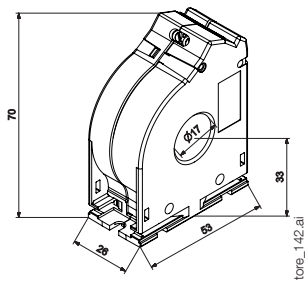

DCT-C-30

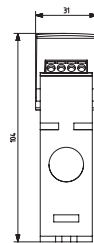

DCT-C-50

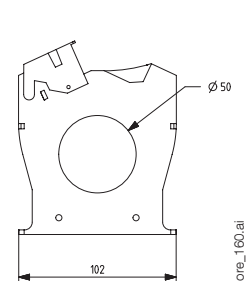
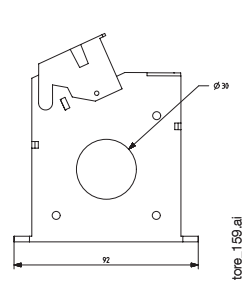

DCT-C-80

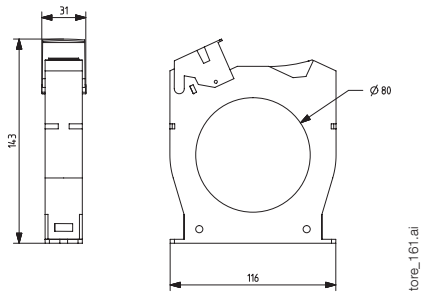

DCT-C-120

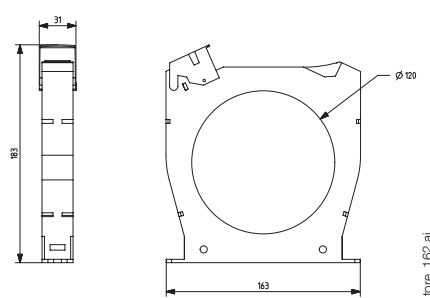

DCT-C-200

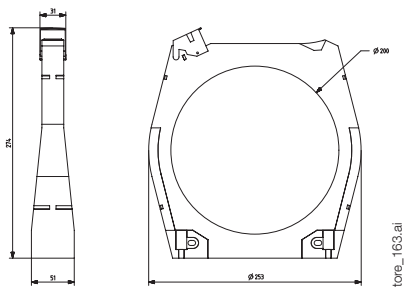

DCT-C-300

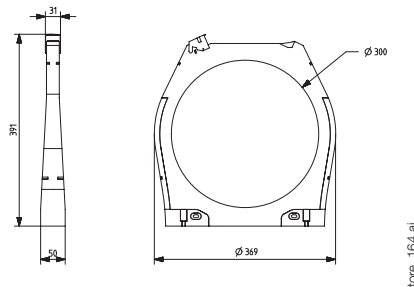

Placement of primary conductors

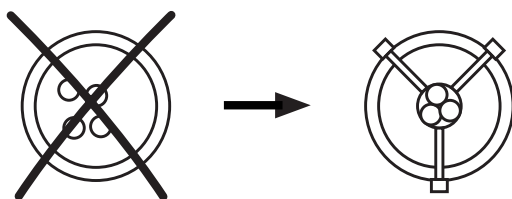

ecom_087_a_1_x_cat.eps

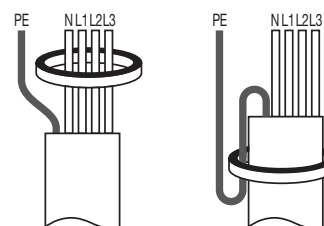

ecom_086_b_1_x_cat.eps

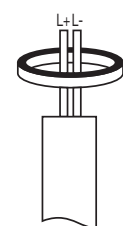

ACCuline DCT-C

Customisable solid-core residual current transformer
from 36 to 630 A per phase – 3 mA to 30 A of fault current

Compatible accessories

Mounting

With a single accessory you are free to mount the core on DIN rail and/or backplate in either orientation (vertical or horizontal).

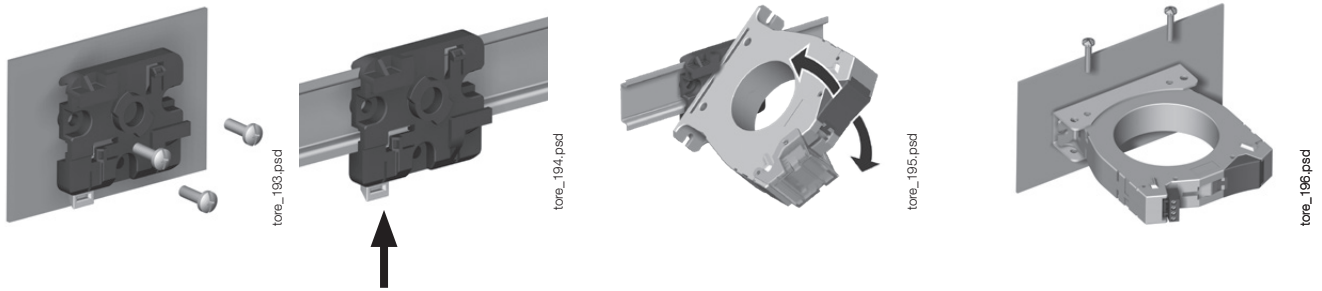

Sealing

Sealing enables the cover to be sealed preventing any unauthorised modification of the connections.



Connection

The quick connection kit simplifies connection of the wires to the secondary of the current transformer, which reduces installation time compared with a terminal block.

