



AC analogue ammeters

Indicators and transducers

Indicators and transducers



ampere_027_eps

Compliance with standards

- > IEC 60051-1
- > IEC 60414
- > NF EN 60051-1
- > DIN 43780
- > NF C 42-010
- > VDE 0410
- > BS 5448
- > BS 89



Function

SOCOME **ferromagnetic ammeters** measure the alternating current of any electrical circuit. They are embedded in the front panel of cabinets, enclosures or other equipment.

Characteristics

- Pointer deflection: 90°.
- DIN and ROTEX indicators.
- Insulation voltage 660 V.
- Dielectric quality: 2 kV - 50 Hz - 1 mn.
- Consumption: 1.1 VA.
- Operating frequency: 45/65 Hz.
- Motor rating 5 I_n; use on motor circuits up to 8 I_n.
- Connection:
 - Screw mounted,
 - With fast-on lugs for any rating ≤ 15 A.
- Rotary switch: interchangeable, driven (protected face).

Composition of the range

| | Case | DIN 48-72-96 | | ROTEX 72-96 | |
|------------------------------------------|-------------------------------------------|--------------|--------|-------------|--------|
| | Pointer deflection | 90° | | 90° | |
| | Connection | direct | 5 A CT | direct | 5 A CT |
| Normal indication (I_n) | Motor indication (5 I_n) | | | | |
| Rating | Rating | | | | |
| 0 - 5 A | 0 - 5 A - 25 A | • | • | • | • |
| 0 - 10 A | 0 - 10 A - 50 A | • | • | • | • |
| 0 - 15 A | 0 - 15 A - 75 A | • | • | • | • |
| 0 - 20 A | 0 - 20 A - 100 A | | • | | |
| 0 - 25 A | 0 - 25 A - 125 A | • | • | • | • |
| 0 - 40 A | 0 - 40 A - 200 A | • | • | • | • |
| 0 - 60 A | 0 - 60 A - 300 A | • | • | • | • |
| 0 - 100 A | 0 - 100 A - 500 A | • | • | | • |

Case

DIN

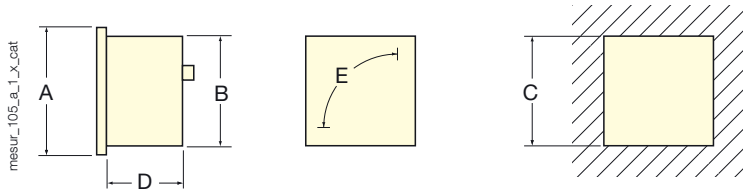

Pointer deflection: 90°

| A | B | C | D | E |
|---------|-------------|--------------------|----|-----|
| 48 x 48 | 44,5 x 44,5 | 45 ^{+0.6} | 59 | 38 |
| 72 x 72 | 66,5 x 66,5 | 68 ^{+0.7} | 58 | 65 |
| 96 x 96 | 89 x 89 | 92 ^{+0.8} | 58 | 100 |

ROTEX

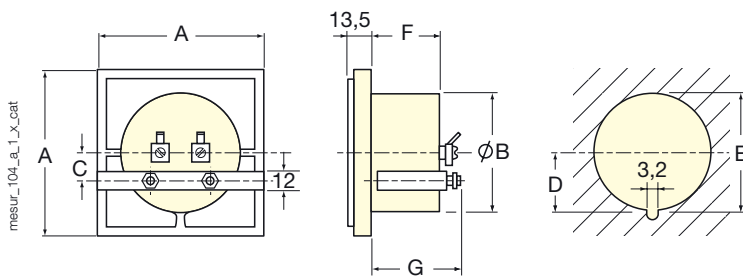

Pointer deflection: 90°

| A | B | C | D | E | F | G |
|---------|------|------|------|--------------------|------|------|
| 72 x 72 | 54,5 | 11 | 28,5 | 56 ^{+0.5} | 34,5 | 50,8 |
| 96 x 96 | 68 | 21,6 | 35,5 | 70 ^{+0.5} | 34,5 | 50,8 |

Connections

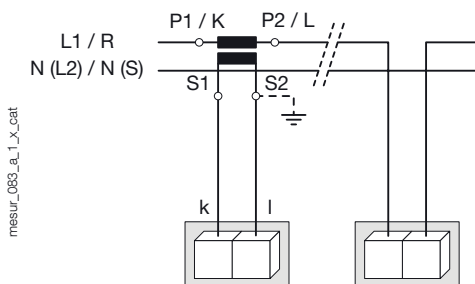

AC analogue ammeters

Indicators and transducers

Normal indication (I_n) with 90° pointer deflection

References

| Direct connection | | | | | |
|-------------------|-----------------------|-----------------------|--|-------------------------|--|
| | DIN 48x48 D48A90-A | DIN 72x72 D72A90-A | | ROTEX 72x72 R72A90-A | |
| Rating | Reference | Reference | | Reference | |
| 0 - 5 A | 192A 1200 | 192A 1300 | | 192C 1300 | |
| 0 - 10 A | 192A 1201 | 192A 1301 | | 192C 1301 | |
| 0 - 15 A | 192A 1202 | 192A 1302 | | 192C 1302 | |
| 0 - 25 A | 192A 1203 | 192A 1303 | | 192C 1303 | |
| 0 - 40 A | 192A 1204 | 192A 1304 | | 192C 1304 | |
| 0 - 60 A | 192A 1205 | 192A 1305 | | | |
| 0 - 100 A | | 192A 1310 | | | |

| Connection to 5 A CT | | | | | |
|----------------------|-----------------------|-----------------------|-----------------------|-------------------------|-------------------------|
| | DIN 48x48 D48A90-A | DIN 72x72 D72A90-A | DIN 96x96 D96A90-A | ROTEX 72x72 R72A90-A | ROTEX 96x96 R96A90-A |
| Rating | Reference | Reference | Reference | Reference | Reference |
| 0 - 5 A | | 192A 3300 | | | |
| 0 - 10 A | 192A 2201 | 192A 3301 | 192A 4401 | 192C 3301 | |
| 0 - 15 A | | 192A 3302 | | 192C 3302 | |
| 0 - 20 A | 192A 2235 | 192A 3335 | | | |
| 0 - 25 A | 192A 2203 | 192A 3303 | | 192C 3303 | |
| 0 - 30 A | | | | 192C 3336 | |
| 0 - 40 A | 192A 2204 | 192A 3304 | | 192C 3304 | |
| 0 - 50 A | 192A 2222 | 192A 3322 | 192A 4422 | 192C 3322 | |
| 0 - 60 A | 192A 2205 | 192A 3305 | | 192C 3305 | |
| 0 - 75 A | | 192A 3323 | | | |
| 0 - 100 A | 192A 2206 | 192A 3306 | 192A 4406 | 192C 3306 | 192C 4406 |
| 0 - 125 A | 192A 2224 | 192A 3324 | | | |
| 0 - 150 A | | 192A 3307 | 192A 4407 | 192C 3307 | 192C 4407 |
| 0 - 200 A | 192A 2220 | 192A 3320 | | 192C 3320 | |
| 0 - 250 A | 192A 2208 | 192A 3308 | | 192C 3308 | 192C 4408 |
| 0 - 300 A | 192A 2221 | 192A 3321 | | 192C 3321 | |
| 0 - 400 A | 192A 2209 | 192A 3309 | 192A 4409 | 192C 3309 | |
| 0 - 500 A | 192A 2225 | 192A 3325 | 192A 4425 | | |
| 0 - 600 A | 192A 2210 | 192A 3310 | 192A 4410 | 192C 3310 | |
| 0 - 750 A | 192A 2230 | | 192A 4430 | 192C 3330 | |
| 0 - 800 A | 192A 2226 | 192A 3326 | | 192C 3326 | |
| 0 - 1000 A | | 192A 3311 | | | 192C 4411 |
| 0 - 1250 A | 192A 2231 | 192A 3331 | | | |
| 0 - 1500 A | | | 192A 4412 | | |
| 0 - 2000 A | | 192A 3328 | 192A 4428 | 192C 3328 | |
| 0 - 2500 A | | 192A 3313 | 192A 4413 | | |

Accessories

| | DIN 48x48 D48A90-A | DIN 72x72 D72A90-A | DIN 96x96 D96A90-A | ROTEX 72x72 R72A90-A | ROTEX 96x96 R96A90-A |
|-----------------------------|-----------------------|-----------------------|-----------------------|-------------------------|-------------------------|
| | Reference | Reference | Reference | Reference | Reference |
| Terminal protection cover | | 192Z 1000 | 192Z 1011 | | |
| 2 safety caps | 192Z 1016 | 192Z 1016 | 192Z 1016 | 192Z 1016 | 192Z 1016 |
| Mounting bracket and screws | 179Z 5000 | 179Z 5010 | 179Z 5010 | 179Z 5020 | 179Z 5022 |
| Gasket | 192Z 0007 | 192Z 0008 | 192Z 0009 | 192Z 0011 | 192Z 0012 |
| Replacement glass | 179Z 2000 | 179Z 2010 | 179Z 2020 | 179Z 2030 | 179Z 2040 |

Motor indication ($5 I_n$) with 90° pointer deflection

References

| Direct connection | | | | | |
|-------------------|-----------------------|-----------------------|--|-------------------------|-------------------------|
| | DIN 48x48 D48A90-A | DIN 72x72 D72A90-A | | ROTEX 72x72 R72A90-A | ROTEX 96x96 R96A90-A |
| Rating | Reference | Reference | | Reference | Reference |
| 0 - 5 A - 25 A | 192B 1200 | 192B 1300 | | 192D 1300 | 192D 1400 |
| 0 - 10 A - 50 A | 192B 1201 | 192B 1301 | | 192D 1301 | 192D 1401 |
| 0 - 15 A - 75 A | 192B 1202 | 192B 1302 | | 192D 1302 | 192D 1402 |
| 0 - 25 A - 125 A | 192B 1203 | 192B 1303 | | 192D 1303 | 192D 1403 |
| 0 - 40 A - 200 A | 192B 1204 | 192B 1304 | | 192D 1304 | |
| 0 - 60 A - 300 A | 192B 1205 | | | | |

| Connection to 5 A CT | | | | | |
|----------------------|-----------------------|-----------------------|-----------------------|-------------------------|-------------------------|
| | DIN 48x48 D48A90-A | DIN 72x72 D72A90-A | DIN 96x96 D96A90-A | ROTEX 72x72 R72A90-A | ROTEX 96x96 R96A90-A |
| Rating | Reference | Reference | Reference | Reference | Reference |
| 0 - 5 A - 25 A | 192B 2200 | 192B 3300 | | 192D 3300 | 192D 4400 |
| 0 - 10 A - 50 A | 192B 2201 | 192B 3301 | 192B 4401 | 192D 3301 | 192D 4401 |
| 0 - 15 A - 75 A | 192B 2202 | 192B 3302 | 192B 4402 | 192D 3302 | 192D 4402 |
| 0 - 20 A - 100 A | 192B 2215 | 192B 3315 | | 192D 3315 | |
| 0 - 25 A - 125 A | 192B 2203 | 192B 3303 | | 192D 3303 | 192D 4403 |
| 0 - 30 A - 150 A | 192B 2216 | 192B 3316 | | 192D 3316 | |
| 0 - 40 A - 200 A | 192B 2204 | 192B 3304 | 192B 4404 | 192D 3304 | 192D 4404 |
| 0 - 50 A - 250 A | 192B 2222 | 192B 3322 | | 192D 3322 | 192D 4422 |
| 0 - 60 A - 300 A | 192B 2205 | 192B 3305 | | 192D 3305 | |
| 0 - 75 A - 375 A | 192B 2223 | 192B 3323 | | 192D 3323 | 192D 4423 |
| 0 - 100 A - 500 A | 192B 2206 | 192B 3306 | 192B 4406 | 192D 3306 | 192D 4406 |
| 0 - 125 A - 625 A | 192B 2224 | 192B 3324 | | 192D 3324 | |
| 0 - 150 A - 750 A | 192B 2207 | 192B 3307 | 192B 4407 | 192D 3307 | 192D 4407 |
| 0 - 200 A - 1000 A | 192B 2220 | 192B 3320 | | 192D 3320 | 192D 4420 |
| 0 - 250 A - 1250 A | 192B 2208 | 192B 3308 | | 192D 3308 | |
| 0 - 300 A - 1500 A | | 192B 3321 | | 192D 3321 | |
| 0 - 400 A - 2000 A | 192B 2209 | 192B 3309 | 192B 4409 | 192D 3309 | |
| 0 - 500 A - 2500 A | 192B 2225 | | 192B 4425 | 192D 3325 | |
| 0 - 600 A - 3000 A | | | | 192D 3310 | |
| 0 - 750 A - 3750 A | | 192B 3317 | | | |
| 0 - 800 A - 4000 A | | | | 192D 3326 | |

Accessories

| | DIN 48x48 D48A90-A | DIN 72x72 D72A90-A | DIN 96x96 D96A90-A | ROTEX 72x72 R72A90-A | ROTEX 96x96 R96A90-A |
|-----------------------------|-----------------------|-----------------------|-----------------------|-------------------------|-------------------------|
| | Reference | Reference | Reference | Reference | Reference |
| Terminal protection cover | | 192Z 1000 | 192Z 1011 | | |
| 2 safety caps | 192Z 1016 | 192Z 1016 | 192Z 1016 | 192Z 1016 | 192Z 1016 |
| Mounting bracket and screws | 179Z 5000 | 179Z 5010 | 179Z 5010 | 179Z 5020 | 179Z 5022 |
| Gasket | 192Z 0007 | 192Z 0008 | 192Z 0009 | 192Z 0011 | 192Z 0012 |
| Replacement glass | 179Z 2000 | 179Z 2010 | 179Z 2020 | 179Z 2030 | 179Z 2040 |